

a family building homes for families™



HOUSE & LAND

\$640,400*

PROVIDENCE – ALFREDTON

Lot 50 Brewster Street
Alfredton VIC 3350



Jade 23 Tega Façade
(Aspirations Series 3)

Home size: 22.58sq Land size: 420.00m²

- ✓ 2KW PV Solar Panels System
- ✓ Heat Pump Electric Hot Water Service
- ✓ NCC 2022 Compliant
- ✓ 7 Star Energy Rating
- ✓ Site Costs Allowance
- ✓ Water Tank
- ✓ NBN/Opticomm/Redtrain/Multinet/CNT Corp. connection
- ✓ Remote control to garage door
- ✓ 900mm Stainless Steel Appliances
- ✓ Technika dishwasher
- ✓ Gas ducted heating
- ✓ TV Antenna
- ✓ Floor Coverings
- ✓ Concrete Crossover
- ✓ 35 m2 of Concrete Drive and Paving
- ✓ 20mm Caesarstone benchtops to kitchen
- ✓ 20mm Caesarstone benchtops to bathroom and ensuite
- ✓ Tiled shower bases
- ✓ Overhead cupboards to laundry (up to 900mm)
- ✓ Laminate laundry cabinet with 45lt stainless steel trough
- ✓ 20 downlights

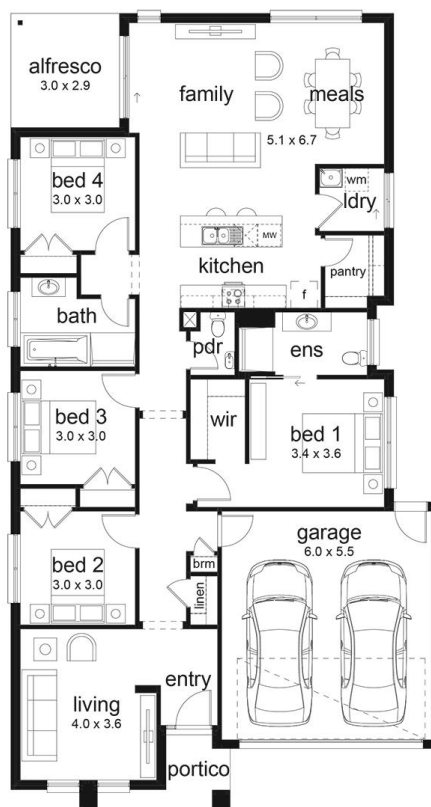

Go to dennisfamily.com.au or call
1800 DENNIS for more information.

Reference HL0047451

*Subject to land and build contracts for specified lot, available until sold. 1. Images not to scale and may differ from final built forms. 2. Landscaping, driveways, retaining walls, paving, decking, fencing, decorator items and furnishings not included. 3. Unless stated, site costs are not fixed, package price may increase depending on: rock removal and services connection costs, retaining walls, tree root mitigation, developer requirements, BAL zoning and other statutory requirements. 4. "Fixed site costs" packages include rock removal and services connection only, exclude retaining walls and tree root mitigation. 5. Price based on facade shown, excludes stamp duty, legal and transaction costs eg FIRE, finance fees. 6. Customers required to enter into a separate land contract with the land developer. 7. Prospective buyers should make and rely on their own enquiries and seek independent legal and financial advice. 8. Package not available in conjunction with any other promotions. 9. Additional options available, additional charges may apply. 10. Alternative facade options available additional charges may apply. © 2022, Dennis Family Homes Pty Ltd ACN 056254249 is a registered building practitioner CDB-U 49195 (Vic) and 173511C (NSW). © 2019, Dennis Family Homes Pty Ltd ACN 056254249 is a registered building practitioner CDB-U 49195 (Vic) and 173511C (NSW).